

*Note: The most current version of these instructions can be found online at [www.grahamfield.com](http://www.grahamfield.com)*

*Tools needed: Phillips screwdriver, 5/8 wrench, two M6 wrenches (you may wish to use appropriate socket or adjustable wrenches instead)*

- ⚠ **WARNING: Important! Read and understand these instructions before assembling or using the GF8902 Overbed Table. If you do not understand any part of these instructions, contact a health-care professional for direction in the use of this product. If the overbed table is not properly assembled and adjusted, personal injury and/or damage to the overbed table could result.**
- ⚠ **WARNING: If components are damaged or missing, contact your dealer immediately. DO NOT use substitute parts. Use only Lumex replacement parts. Non-Lumex replacement parts could cause personal injury and/or damage to overbed table.**
- ⚠ **WARNING: GF Health Products, Inc. assumes no responsibility for any damage or injury caused by improper assembly or use of this product.**

### ASSEMBLY INSTRUCTIONS

#### Unpacking

1. Open end of box.
2. Slide contents out of box.
3. Collect base, table top, column, and hardware.

#### Assembly (see picture at right)

- ⚠ **WARNING: Do not remove the black screw (13) from the column (2) before the table is completely assembled and in upright position; the table top could rise suddenly and cause serious personal injury.**

- ⚠ **WARNING: The column is spring-loaded — DO NOT disassemble the column; this could cause serious personal injury.**

1. Place table top (1) upside down on level surface.
2. Ensure the release rod (not shown, inside column) is fully inside the column (2), then insert the column tongue into the table top bracket (5) as shown at right. Align the tongue and bracket holes. Insert — but do not tighten — the two Phillips screws (6) and washers (6) as shown through bracket into tongue.
3. Position the release lever (3) as shown, with curved side facing table top, and install in column. Match the release lever and bracket alignment holes, then insert hex bolt (4) through both to secure release lever to bracket. Install hex nut (4) on bolt. Use two M6 wrenches to tighten. Use a Phillips screwdriver to now tighten the Phillips screws (6) that secure bracket to tongue.
4. Note orientation of base caster holes, facing away from table top as shown, and place the base (7) above the column. Install the two large hex bolts (12) through the bolt plate (11), bolt sleeves (10), base, and into the end of the column as shown. Use a 5/8 wrench to tighten the bolts.
5. Install the casters (8) and (9) as shown: press the casters in until they lock into place.
6. TURN THE TABLE UPRIGHT and place it on the floor. Use a Phillips screwdriver to remove the black screw (13); discard it and replace it with the chrome screw (14). Use a Phillips screwdriver to tighten the screw.

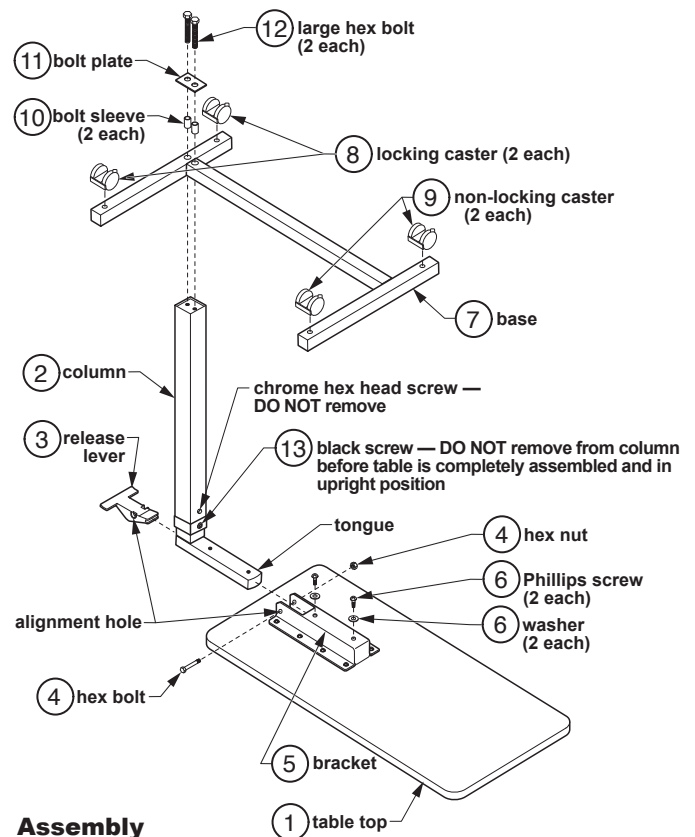

7. Remove protective film from table top surface.

**⚠ WARNING: Ensure that the table is assembled as described, and that all components are securely attached, before use.**

## **OPERATION INSTRUCTIONS**

**⚠ WARNING: Do not lean on the suspended end of the table top; this may cause the table to tip.**

**⚠ WARNING: The table supports up to 30 lb of dispersed weight. Do not exceed this limit.**

### **To raise the table top**

To raise the table top, apply light pressure upward at any point on bottom of table top and stop when the table top has reached the desired height.

### **To lower the table top**

To lower the table top, squeeze the release lever upward while pushing the table top down at column until table top has reached the desired height. Do not put pressure on table top end opposite column. Column will lock when lever is released.

### **To lock and unlock casters**

The two column-end casters have step-on locks. Step on locks to lock casters; pull locks up to unlock casters.

## **MAINTENANCE**

Check the fit and tightness frequently of all hardware to ensure that the table is securely assembled.

### **Cleaning**

1. To clean: Gently wipe the table with a soft, clean, damp cloth.

**▲ CAUTION: Do not use cleansers that may damage the table's finish.**

2. To wash more thoroughly: Clean with mild soap and water.

3. Dry table with a clean, soft cloth.

## **WARRANTY**

GF Health Products, Inc. offers a one-year limited warranty against manufacturer's defects on the Lumex® GF8902 Standard Non-Tilt Overbed Table. If a product is deemed to be under warranty, GF Health Products, Inc. shall provide, at its option, (1) replacement of any defective part or product or (2) a credit of the original selling price made to GF Health Products, Inc.'s initial customer. The warranty does not include any labor charges incurred in replacement part(s) installation or any associated freight or shipping charges to GF Health Products, Inc.

The warranties contained herein contain all the representations and warranties with respect to the subject matter of this document, and supersede all prior negotiations, agreements and understandings with respect thereto. The recipient of this document hereby acknowledges and represents that it has not relied on any representation, assertion, guarantee, warranty, collateral contract or other assurance, except those set out in this document.



GF Health Products, Inc. is not responsible for typographical errors. Packaging, warranties, products and specifications are subject to change without notice. Graham-Field® and Lumex® are registered trademarks of GF Health Products, Inc.

© 2010 GF Health Products, Inc. • 2935 Northeast Parkway • Atlanta, GA 30360 • tel 800-347-5678 • fax 800-721-0601 • Made in China