

# REHAB SHOWER COMMODORE

## PARTS CATALOG

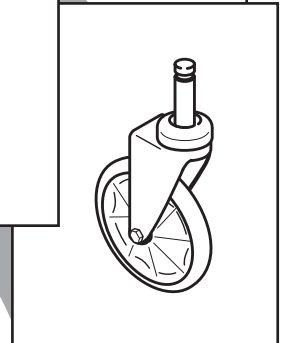
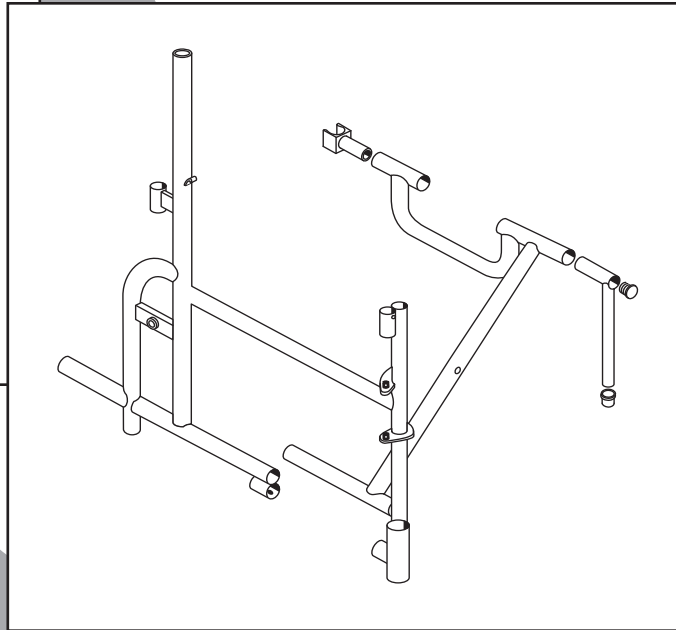
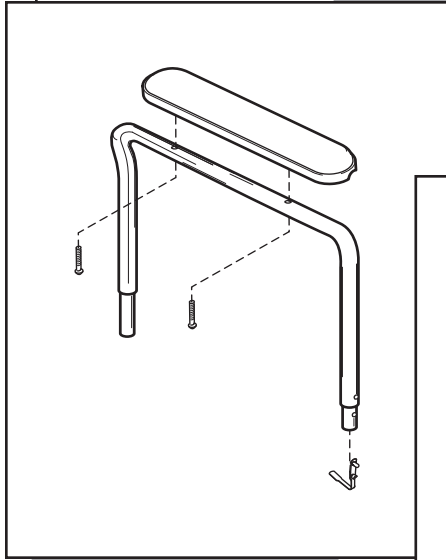

# CONTENTS

---

SIDEFRAME AND CROSSBRACE .....	3
SEAT .....	4
PAIL AND LID, PAN HOLDER.....	4
BACK UPHOLSTERY .....	5
ARM .....	5
FOOTREST .....	6
FRONT CASTER .....	6
REAR WHEEL .....	7
WHEEL LOCK .....	7

## TO ORDER

Tel: 770-368-4700 • Fax: 770-368-2386

Returns: Parts may not be returned without prior authorization from GF Health Products, Inc. Custom parts cannot be returned for credit. Please refer to GF Health Products, Inc. Terms and Conditions for further information.

GF Health Products, Inc. is not responsible for typographical errors. All illustrations, specifications, packaging and warranties contained in this catalog are based on the latest product information available at the time of printing. The most current product information, including the most current revision of this catalog, can be found online at [www.grahamfield.com](http://www.grahamfield.com).

Everest & Jennings, E&J, and Graham-Field are registered trademarks of GF Health Products, Inc.

© 2005, GF Health Products, Inc., All Rights Reserved

# SIDEFAME AND CROSSBRACE

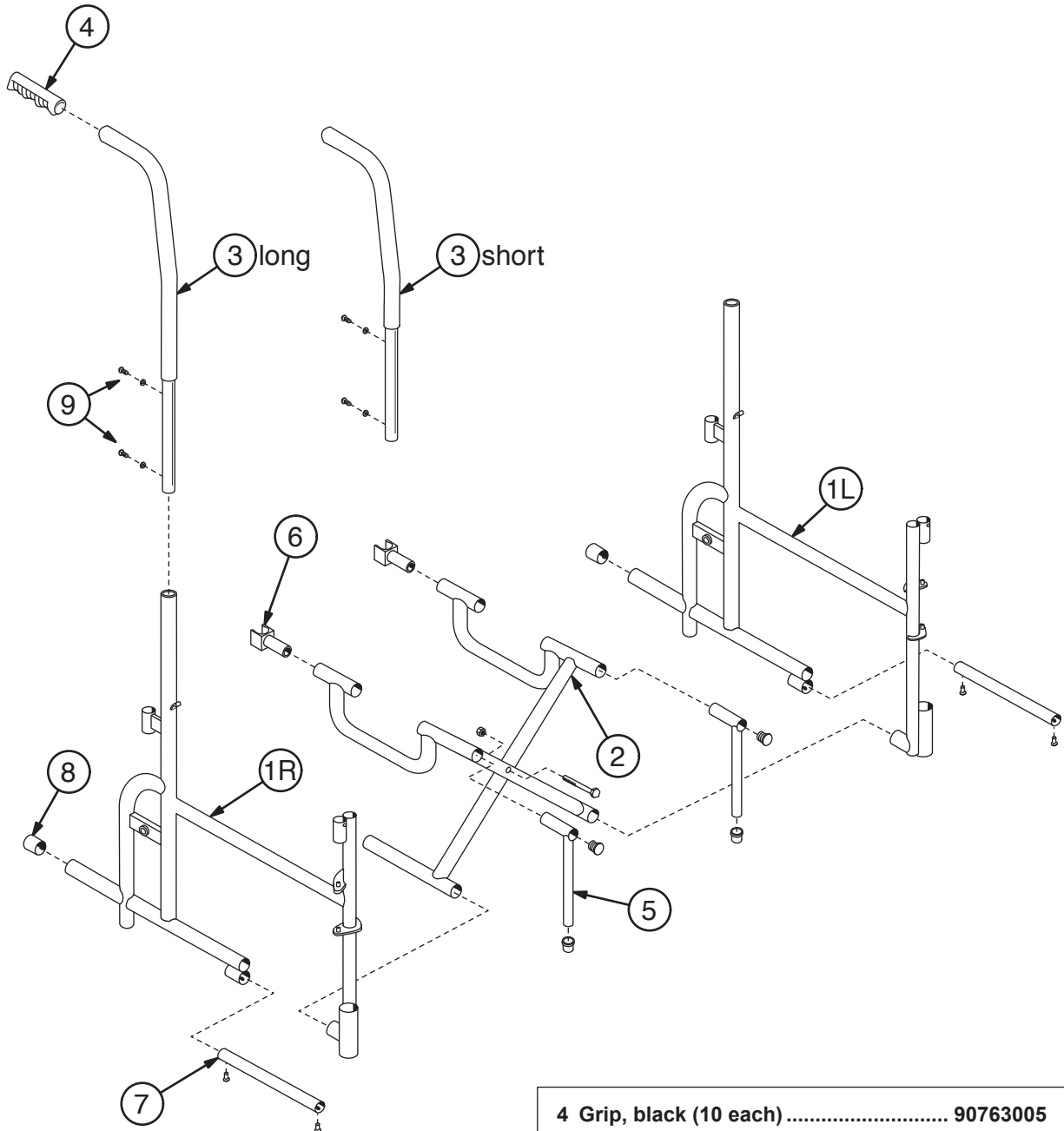

- 1 Sideframe, each**  
     Right ..... 90835201  
     Left..... 90835202
- 2 Crossbrace, pair (includes center bolt and nut)** ..... 9P835211
- 3 Backpost / push handle, pair (includes Item 9 mounting hardware)**  
     Short (14-1/2")..... 9P835228  
     Long (17-1/2") ..... 9P835230

- 4 Grip, black (10 each)** ..... 90763005
- 5 Front slide post kit (includes 1 each front slide post, seat rail plug and bushing)**  
     ..... 90H35218
- 6 Seat rail guide (10 each)** ..... 90763015
- 7 Bottom inner rail, pair (includes 2 each bottom inner rail and 4 each rivets)....** 9P835209
- 8 Tipping sleeve (10 each)**..... 90763006
- 9 Mounting hardware, pack, for backpost / push handle (includes 4 each Phillips head screw and lock washer).....** 9P835231

## SEAT

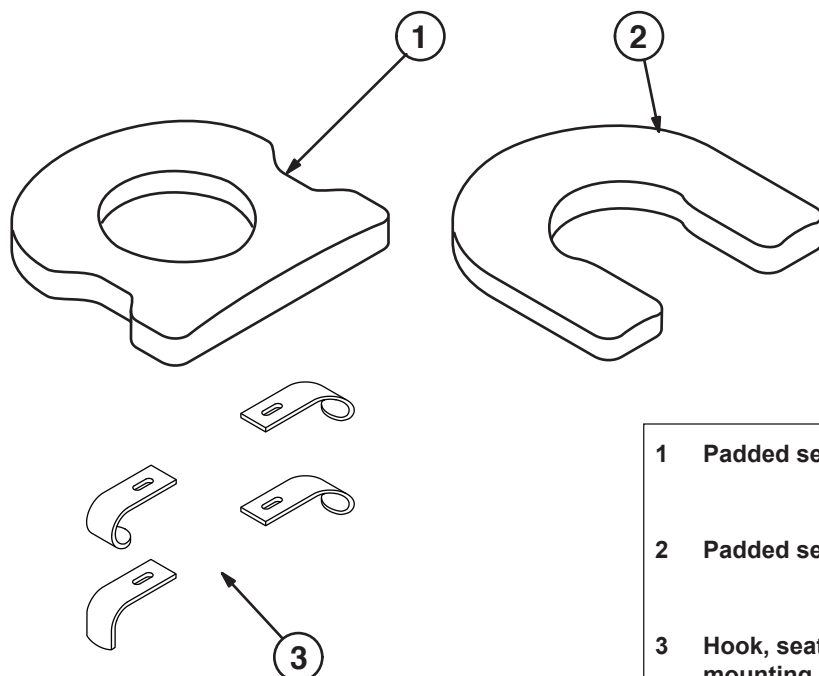

- |   |   |          |
|---|---|----------|
| 1 | Padded seat, oval cutout (includes hooks)         | 90835070 |
| 2 | Padded seat, open front (includes hooks)          | 90835175 |
| 3 | Hook, seat (set of 4, includes mounting hardware) | 90H35081 |

## PAIL AND LID, PAN HOLDER

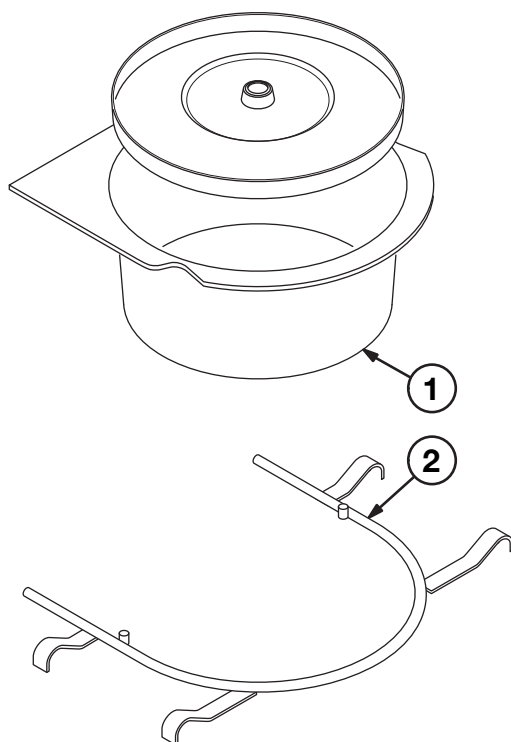

- |   |                      |          |
|---|----------------------|----------|
| 1 | Commode pail and lid | 90H43170 |
| 2 | Pan holder           | 90835115 |

## BACK UPHOLSTERY

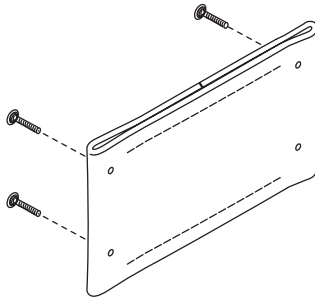

Back upholstery kit (includes back upholstery and mounting hardware)

.....90H35060

## ARM

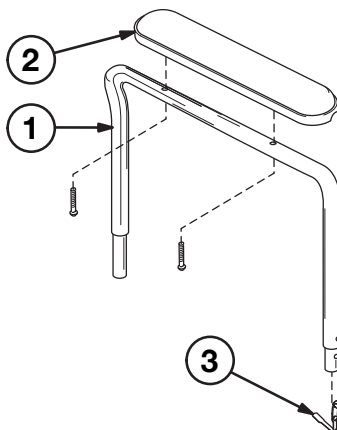

1 Arm kit (includes right and left full-length arm with spring lock (does not include arm pad) .....9P835215

2 Arm pad kit (includes 2 black plastic full-length arm pads and mounting screws) .....9P190E01

3 Spring lock (10 each) .....9B232870

# FOOTREST

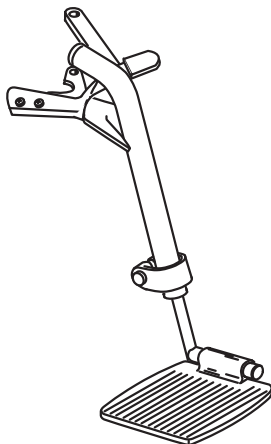

Footrest kit, pair (left shown) includes  
right and left hanger, release, and  
footplate with extension .....90761752

# FRONT CASTER

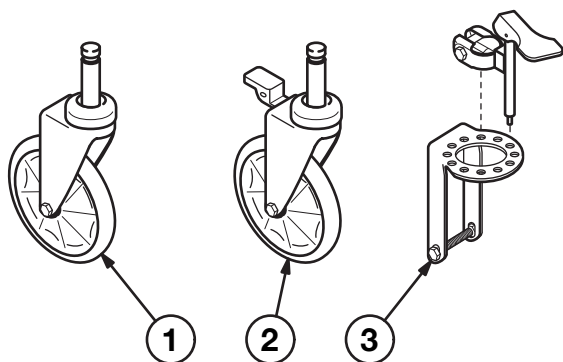

## Current caster: 5" x 1 1/4" tire

- 1 Caster, 5" x 1 1/4" tire, pair  
(includes wheel, fork, bearings, axle  
and axle nut) .....9P835330
- 2 Caster, 5" x 1 1/4" tire, with step-on lock, pair  
(includes wheel with step-on lock, fork,  
bearings, axle and axle nut) .....9P835331
- 3 \* Caster pin lock for 5" x 1 1/4" tire, pair  
(does not include wheel) ..... 9P292900

## Discontinued caster: 5" x 7/8" tire

- 1 Caster, 5" x 7/8" tire, pair  
(includes wheel, fork, bearings, axle  
and axle nut) .....9P054200
- 2 Caster, 5" x 7/8" tire, with step-on lock  
(includes wheel with step-on lock, fork,  
bearings, axle and axle nut) .....9P054210
- 3 \* Caster pin lock for 5" x 7/8" tire, pair  
(does not include wheel) .....9P292850

Note: Caster pin locks for 1 1/4" tires are not usable  
with 7/8" tires; caster pin locks for 7/8" tires  
are not usable with 1 1/4" tires.

## REAR WHEEL

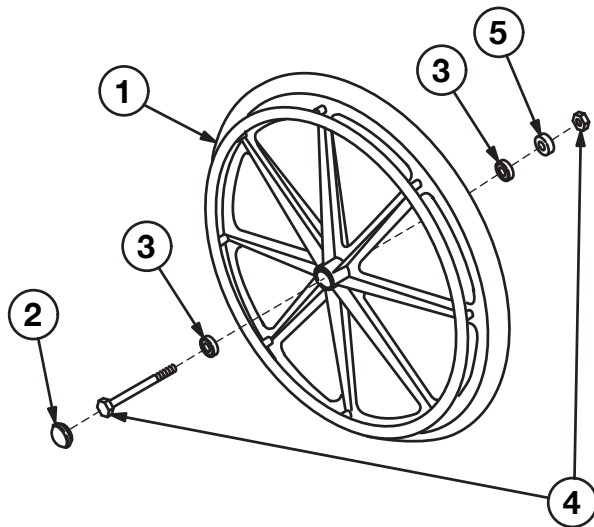

- |   |          |
|---|----------|
| 1 Rear wheel, each, 1" solid rubber tire, integral handrims (includes hub cap and bearings; does not include axle or nut) ..... | 90-011B1 |
| 2 Hub cap (10 each).....  | 9B045035 |
| 3 Wheel bearing (10 each) .....   | 9B007700 |
| 4 Rear axle and nut (10 each).....  | 9B-47320 |
| 5 Axle spacer (10 each).....  | 9B007360 |

## WHEEL LOCK

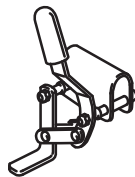

- |   |          |
|---|----------|
| Wheel lock, pair, push-to-lock (includes rubber tip)..... | 9P123011 |
| Rubber tip, wheel lock (10 each).....                     | 90763063 |

Everest & Jennings®

**GF Health Products, Inc.  
2935 Northeast Parkway  
Atlanta, Georgia 30360 USA**

**tel: 770-368-4700  
fax: 770-368-2386**



**GRAHAM-FIELD**

**[www.grahamfield.com](http://www.grahamfield.com)**

**Rehab Shower Commode Parts Catalog  
GF1500003RevA15**