

## FR566G DELUXE CLINICAL CARE RECLINER: REPLACEMENT PARTS LIST

**TO ORDER: Tel: 1.770.368.4700 • Fax: 1.770.368.2386 • [www.grahamfield.com](http://www.grahamfield.com)**

**Returns: Parts may not be returned without prior authorization from GF Health Products, Inc. Custom parts cannot be returned for credit. Please refer to GF Health Products, Inc. Terms and Conditions for further information.**



ITEM	ITEM NUMBER	DESCRIPTION	UNIT OF MEASURE
1	5792A001G	TABLE, SIDE, FITS ALL CLINICAL CARE RECLINERS	1 EA
2	5792A002	HARDWARE, CLEVIS PIN W WASHER SIDE TABLE	4 EA / SET
3	5660C001G	TRENDELENBURG RELEASE BAR	1 EA
4	PV860122	566 RUBBER GRIP - TRENDDEL BAR	1 EA
5	58735J(COLOR CODE)FR	ARMREST, UPHOLSTERED FOR FR566 / FR577 / FR587	1 EA
6	56606J(COLOR CODE)FR	FOOTREST, UPHOLSTERED FOR FR566G AND FR566DG	1 EA
7	56604J(COLOR CODE)FR	LEGREST, UPHOLSTERED FOR FR566G AND FR566DG	1 EA
8	56601J(COLOR CODE)FR	SEAT, UPHOLSTERED FOR FR566G AND FR566DG	1 EA
9	56605J(COLOR CODE)FR	SIDE PANELS, UPHOLSTERED	1 EA
10	AP020004-8	HARDWARE, PUSH PIN AND SPRING SIDE PANELS	1 PR

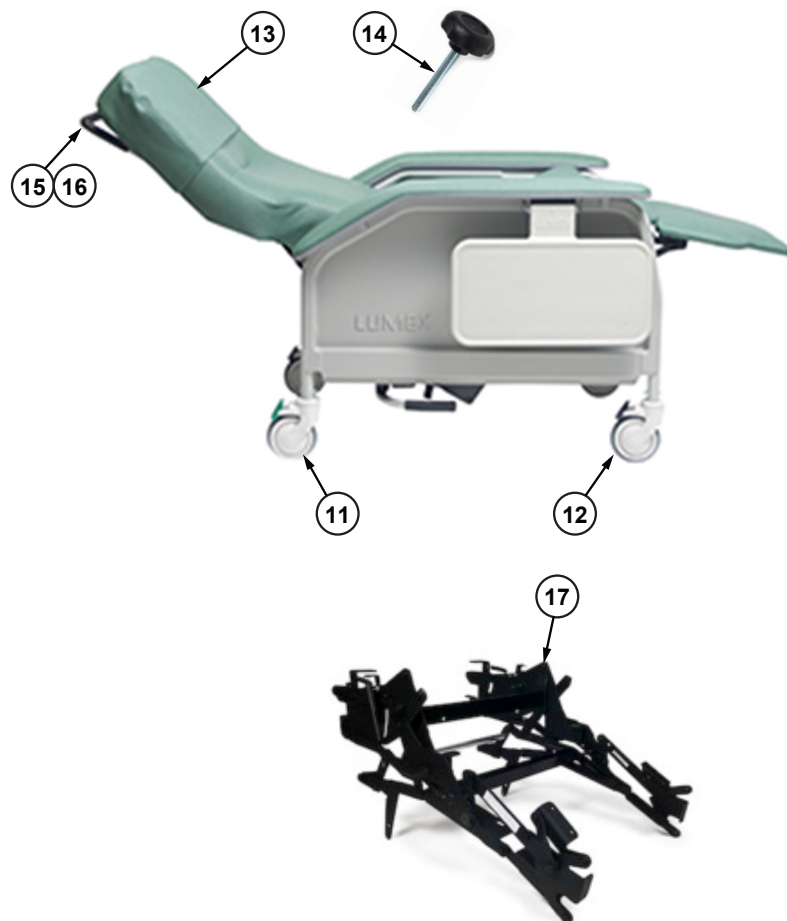

ITEM	ITEM NUMBER	DESCRIPTION	UNIT OF MEASURE
11	CSTRTGRN01	CASTER DIRECTIONAL GREEN TAB TENTE	1 EA
12	CSTRTBLK01	CASTER, SWIVEL LOCKING BLACK TAB TENTE	1 EA
13	56602J(COLOR CODE)FR	BACK, UPHOLSTERED FOR FR566G AND FR566DG	1 EA
14	PP460007	HARDWARE, BACK ATTACHMENT THUMB SCREWS FOR FR566G AND FR566DG	1 EA
15	5772A216G	PUSH HANDLE, WITH GRIP	1 EA
16	9205A	PUSH BAR, GRIP FOR 5873C400A	1 EA
17	5660A200	MECHANISM, RECLINER	1 EA
18	LRMP0001	PAINT TOUCH-UP LUMEX GRAY (not shown)	1 EA



1.770.368.4700

Information contained herein is subject to change.  
The most current and complete product information can be found on our website.  
[www.grahamfield.com](http://www.grahamfield.com)



© 2010, GF Health Products, Inc. All Rights Reserved.  
Graham-Field and Lumex are trademarks of GF Health Products, Inc.  
GF Health Products, Inc. is an ISO 13485 Certified Company.