

REHAB SHOWER COMMODE PARTS CATALOG

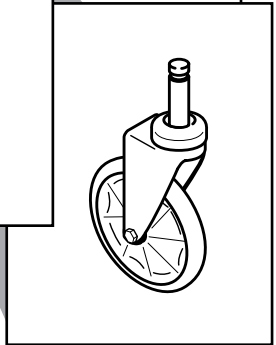
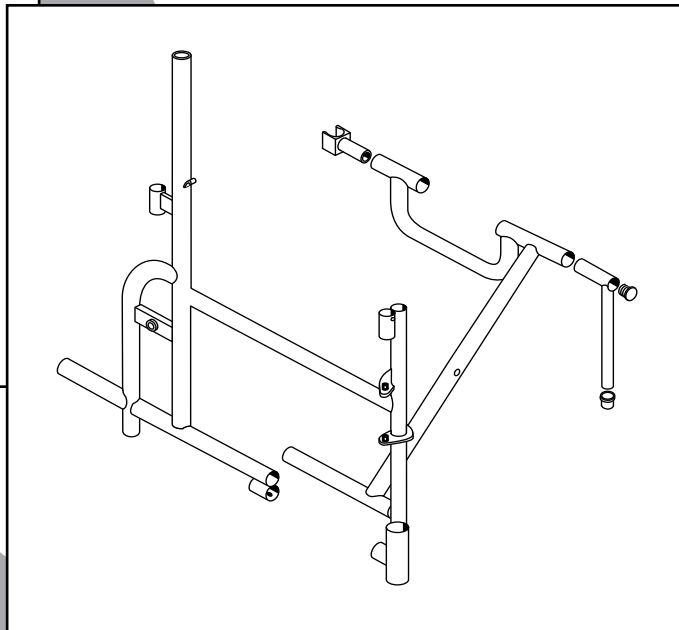
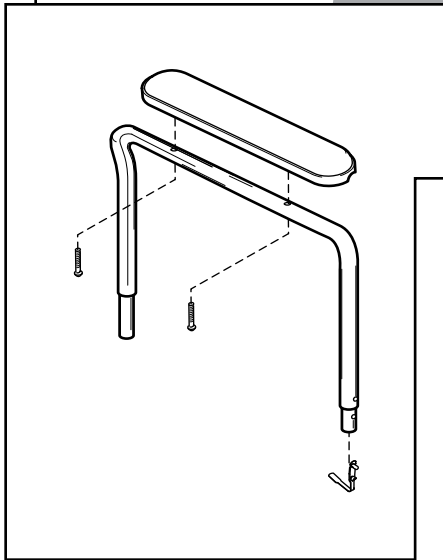

CONTENTS

SIDEFAME AND CROSSBRACE	3
SEAT	4
PAIL AND LID, PAN HOLDER.....	4
BACK UPHOLSTERY.....	5
ARM	5
FOOTREST	6
FRONT CASTER	6
REAR WHEEL	7
WHEEL LOCK	7

TO ORDER

Tel: 1.770.368.4700 • Fax: 1.770.368.2386

Returns: Parts may not be returned without prior authorization from GF Health Products, Inc. Custom parts cannot be returned for credit. Please refer to GF Health Products, Inc. [Terms and Conditions](#) for further information.

SIDEFAME AND CROSSBRACE

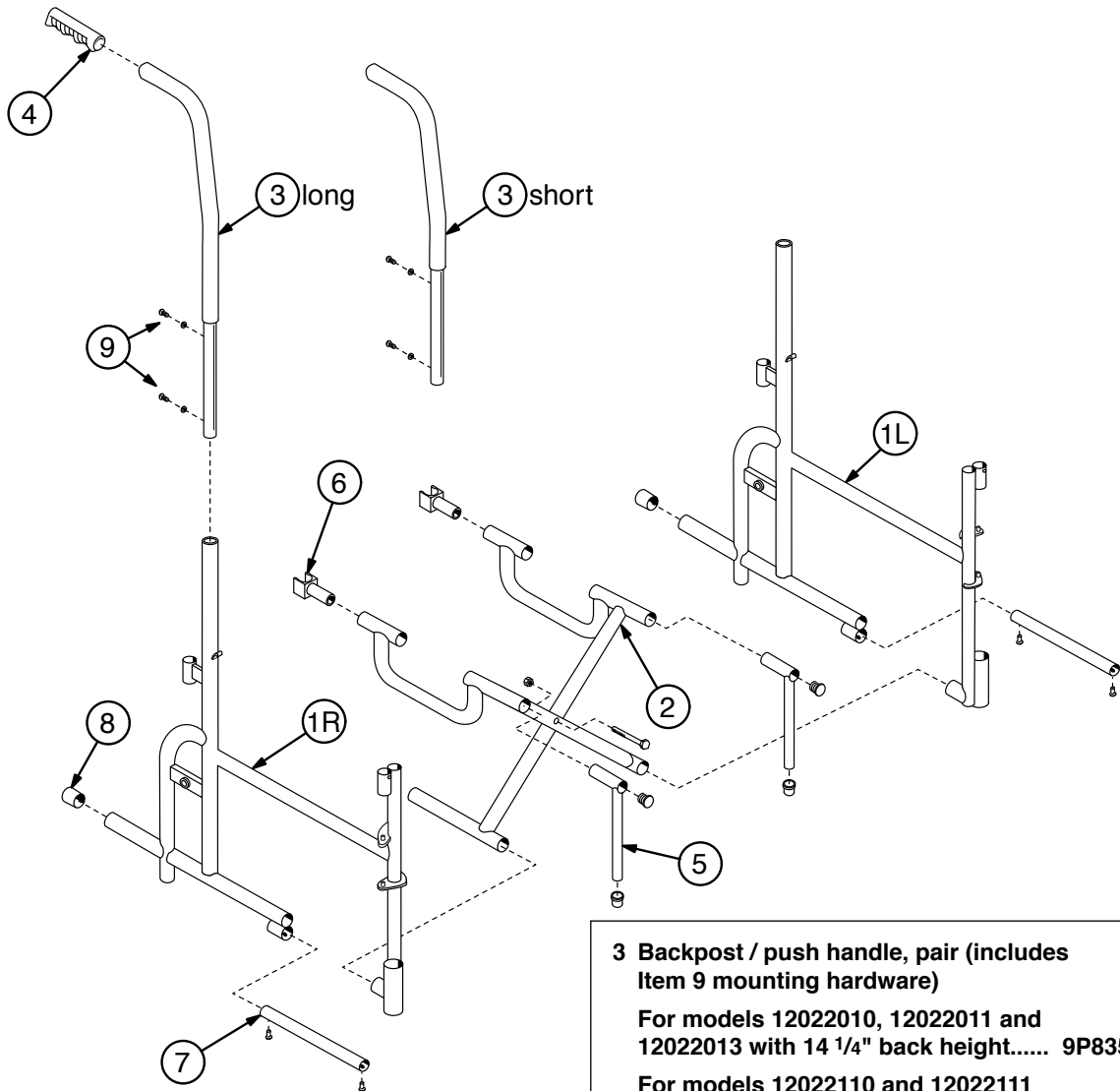

1 Sideframe, each	
For models 12022010, 12022011, 12022013, 12022110 and 12022111 with 14 1/4" and 17 1/4" back height	
Right	90835201
Left	90835202
For models 12023010 and 12023110 with 16" and 19" back height	
Right	90835203
Left	90835204
2 Crossbrace, pair (includes center bolt and nut)	
For models 12022010, 12022011, 12022013, 12022110 and 12022111 with 14 1/4" and 17 1/4" back height	
.....	9P835211
For models 12023010 and 12023110 with 16" and 19" back height	
.....	9P835212

3 Backpost / push handle, pair (includes Item 9 mounting hardware)	
For models 12022010, 12022011 and 12022013 with 14 1/4" back height.....	
9P835228	
For models 12022110 and 12022111 with 17 1/4" back height	
9P835230	
For model 12023010 with 16" back height	
9P835232	
For model 12023110 with 19" back height	
9P835233	
4 Grip, black (10 each)	90763005
5 Front slide post kit (includes 1 each front slide post, seat rail plug and bushing)	
.....	90H35218
6 Seat rail guide (10 each)	90763015
7 Bottom inner rail, pair (includes 2 each bottom inner rail and 4 each rivets)...	
.....	9P835209
8 Tipping sleeve (10 each)	90763006
9 Mounting hardware, pack, for backpost / push handle (includes 4 each Phillips head screw and lock washer).....	
.....	9P835231

SEAT

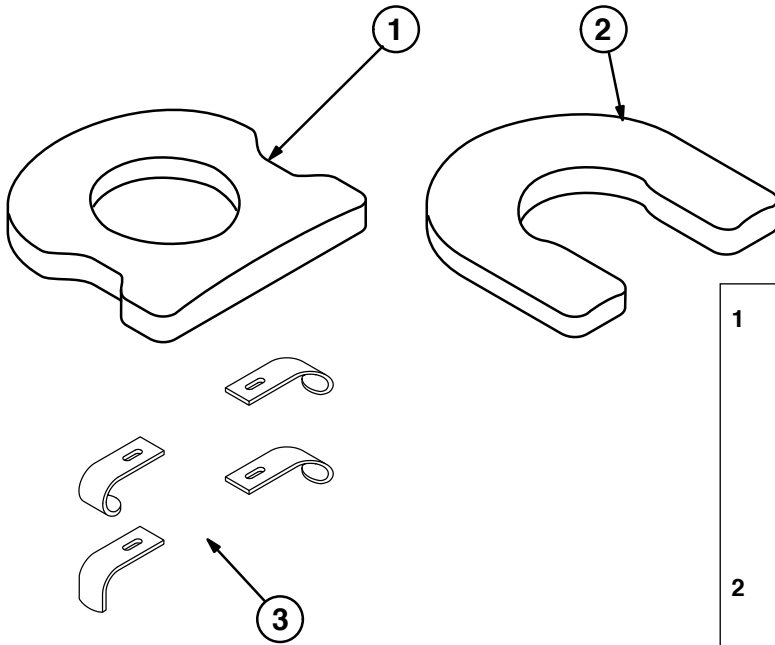

- | | |
|----------|--|
| 1 | Padded seat, oval cutout (includes hooks)
For models 12022010, 12022011,
12022013, 12022110 and 12022111
with 14 1/4" and 17 1/4" back height
..... 90835070 |
| | For models 12023010 and 12023110
with 16" and 19" back height
..... 90835071 |
| 2 | Padded seat, open front (includes hooks)
For models 12022010, 12022011,
12022013, 12022110 and 12022111
with 14 1/4" and 17 1/4" back height <i>only</i>
..... 90835175 |
| 3 | Hook, seat (set of 4, includes
mounting hardware) 90H35081 |

PAIL AND LID, PAN HOLDER

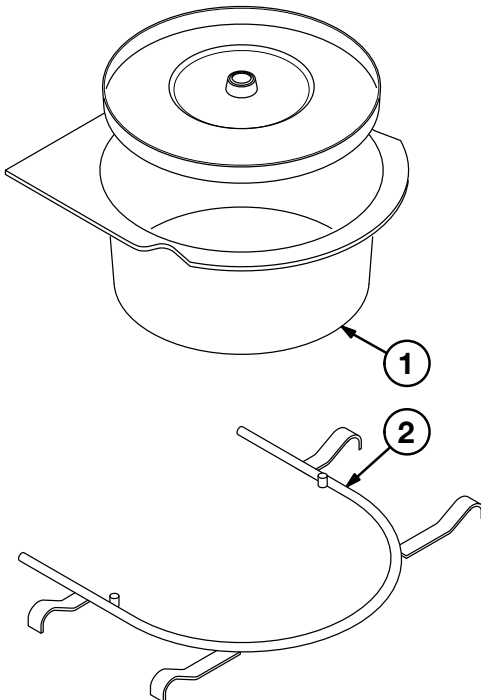

- | | |
|----------|--|
| 1 | Commode pail and lid 90H43170 |
| 2 | Pan holder
For models 12022010, 12022011,
12022013, 12022110 and 12022111
with 14 1/4" and 17 1/4" back height
..... 90835115 |
| | For models 12023010 and 12023110
with 16" and 19" back height
..... 90835116 |

BACK UPHOLSTERY

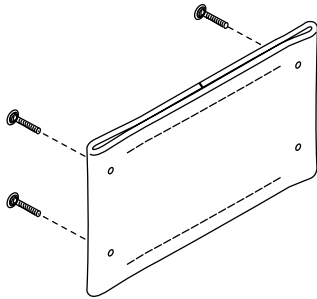

Back upholstery kit (includes back upholstery and mounting hardware)

For models 12022010, 12022011, 12022013, 12022110 and 12022111 with 14 1/4" and 17 1/4" back height
 90H35060

For models 12023010 and 12023110 with 16" and 19" back height
 90H35061

ARM

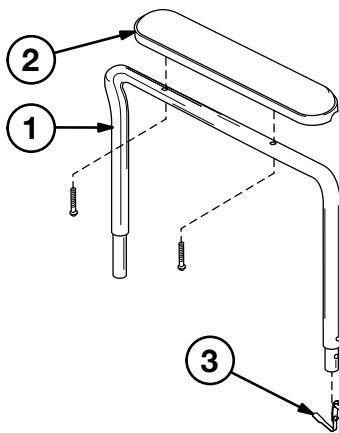

1 Arm kit (includes right and left full-length arm with spring lock (does not include arm pad))

For models 12022010, 12022011, 12022013, 12022110 and 12022111 with 14 1/4" and 17 1/4" back height
 9P835215

For models 12023010 and 12023110 with 16" and 19" back height
 9P835216

2 Arm pad kit (includes 2 black plastic full-length arm pads and mounting screws)..... 9P190E01

3 Spring lock (10 each) 9B232870

FOOTREST

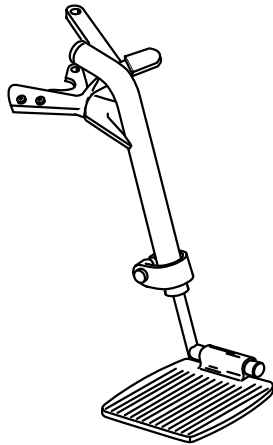

Footrest kit, pair (left shown) includes right and left hanger, release, and footplate with extension

Regular 90761752
 Long 90761752L

FRONT CASTER

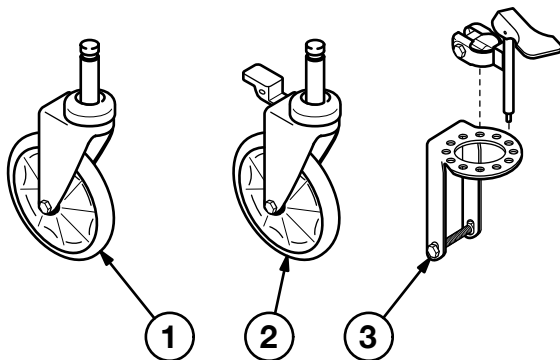

Caster: 5" x 1 1/4" tire

- 1 Caster, 5" x 1 1/4" tire, pair (includes wheel, fork, bearings, axle and axle nut) 9P835330
- 2 Caster, 5" x 1 1/4" tire, with step-on lock, pair (includes wheel with step-on lock, fork, bearings, axle and axle nut) 9P835331
- 3 * Caster pin lock for 5" x 1 1/4" tire, pair (does not include wheel) 9P292900

REAR WHEEL

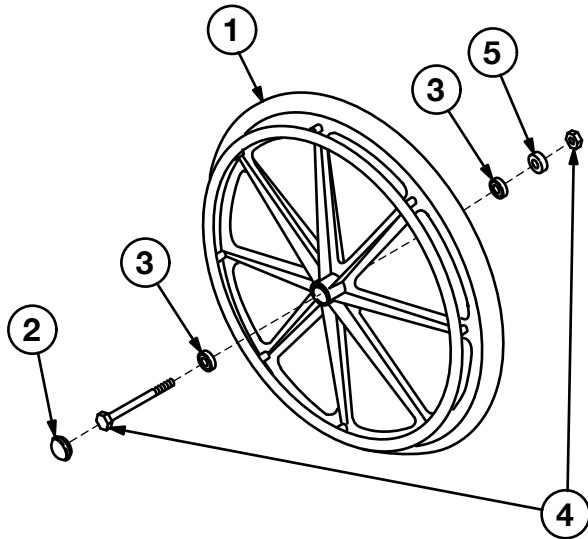

1 Rear wheel, each, 1" tire, includes hub cap and bearings; does not include axle or nut

With solid rubber tire and integral handrims; for models 12022010, 12022011, 12022013, 12022110 and 12022111 with 14 1/4" and 17 1/4" back height

..... 90-011B1

With nylon tire, includes handrims; for models 12023010 and 12023110 with 16" and 19" back height

..... 90-011D1

2 Hub cap (10 each)

For solid rubber tire..... 9B045035

For nylon tire..... 9B045036

3 Wheel bearing (10 each) 9B007700

4 Rear axle and nut (10 each)..... 9B-47320

5 Axle spacer (10 each)..... 9B007360

WHEEL LOCK

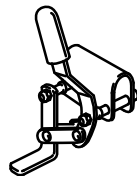

Wheel lock, pair, push-to-lock (includes rubber tip)

For models 12022010, 12022011, 12022013, 12022110 and 12022111 with 14 1/4" and 17 1/4" back height

..... 9P123011

For models 12023010 and 12023110 with 16" and 19" back height

..... 9P123012

Rubber tip, wheel lock (10 each)..... 90763063



1.770.368.4700

Information contained herein is subject to change.
The most current and complete product information can be found on our website.
www.grahamfield.com

Follow us on  

© 2005, GF Health Products, Inc. All Rights Reserved.
Everest & Jennings is a trademark of GF Health Products, Inc.,
One Graham-Field Way, Atlanta GA 30340-3140

GF Health Products, Inc. is an ISO 13485 Certified Company.